

Overview of the G.U-SECURY range

Proven on house and flat entrance doors

G.U offers an extended programme of multipoint door locks for house, flat and secondary entrance doors of timber, PVC and aluminium. G.U-SECURY door locks are highly approved by the great practical benefit they provide to our customers.

The programme

- SECURITY Automatic
- SECURITY MR (massive deadbolts)
- SECURITY SH (hook bolts)
- SECURITY DR (double bolts)
- SECURITY R (rollers)
- SECURITY Rebate shoot bolt

For the complete range including accessories see our order catalogue.

ferGUard*silver

All SECURITY hardware components come with the proven surface sealing ferGUard*silver.

This high quality finish has superb anti-corrosive characteristics providing long-lasting surface quality.

Moreover, ferGUard*silver meets future EU standards of environment protection already today !



**Automatic multipoint locking:
G.U-SECURY Automatic –**
The lock with the click

Integrated safe-T-catch
(optional)

**G.U-SECURY Automatic
with A-opener and
SECURITY COMFORT**
(optional)

**BKS security locking
cylinder janus®**

Tests / Certificates

DIN 18251-3 class 3 and 4

DIN 18250

VdS class A

EN 179 and EN 1125

WK2 to WK4 according to EN 1627 to EN 1630

G.U-SECURY Automatic

Automatic latchbolt

Additional locking component at the top providing optimum security. Automatic latchbolt projection from 10 mm to 20 mm thanks to the integrated trigger lever. The non-handed latchbolt is secured against being forced back.

Lock case

Fully enclosed for optimum protection of the interior functional components. With fixing holes for backplate or rosette.

Latch

Rh/lh reversible. Variant for fire protection doors as an option.

Follower

Holds the square spindle of the handle without play, thus providing reliable operation of the lock. Variant for fire protection doors as an option.

Deadbolt

Single throw of 20 mm.

Centres

Cylinder bore

For profile cylinder or round cylinder Ø 22 mm.

Backset

Forend

ferGUard[®]silver, painted or stainless steel.

Automatic latchbolt at the bottom

Additional locking component at the bottom providing optimum security. Automatic latchbolt projection from 10 mm to 20 mm thanks to the integrated trigger lever. The non-handed latchbolt is secured against being forced back.

G.U-SECURY Automatic

Suited for **WK 2** or **WK 3** (depending on the door element)



G.U-SECURY Automatic

The door that locks itself !

G.U-SECURY Automatic provides security – automatically and immediately. By simply closing the door, without locking it, the door is multipoint locked with the latchbolts throwing 20 mm.

The two latchbolts are secured against being forced back.

A decisive progress in today's securing technology for entrance doors.

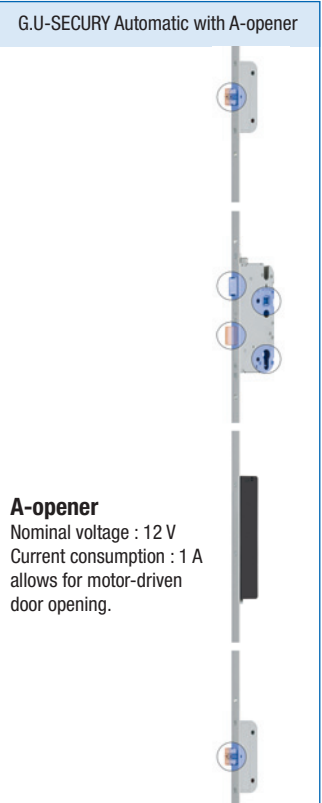

A-opener
Nominal voltage : 12 V
Current consumption : 1 A
allows for motor-driven door opening.

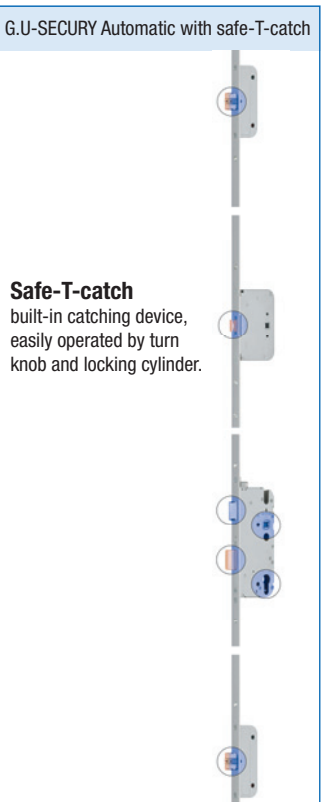

Safe-T-catch
built-in catching device, easily operated by turn knob and locking cylinder.

Unlocking

From outside, the release of the door pulled shut is effected by a turn of the key, from inside via door handle.

VdS tested to class A



Entrance doors equipped with G.U-SECURY Automatic are

tested for WK 2 and WK 3



The advantages

- Increased burglary protection.
- The door is prevented from warping since it is **always locked !**
- Thanks to the reversible latches and latchbolts, the door locks are non-handed.
- Extensive range of G.U-SECURY accessories.
- Latchbolts secured against being forced back.
- Handicapped-suitable to DIN 18025.

Variants

- Automatic
- Automatic with A-opener
- Automatic with safe-T-catch
- Automatic with panic function / fire protection

G.U-SECURY Automatic comes with all current centres, backsets, forends and followers for timber, PVC and aluminium doors.